

Release note - Customize Help image

21 January 2022

What's new

You can now **customize the image** in our Assistant Help feature.

If you offer your users additional support with Userlane's Assistant Help feature, you can display a custom image instead of the default Help image.

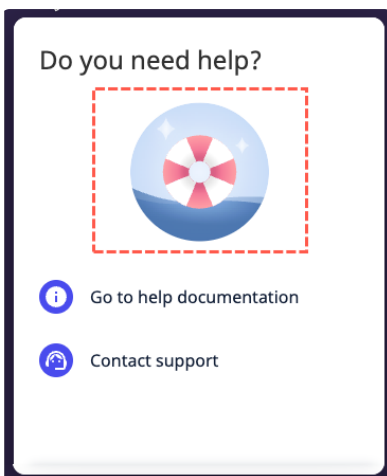

To change the Help image:

1. Go to **Customize > Design** in the Portal.
2. Locate *Help Desk* in the right sidebar.
3. Click **Upload Image**.
4. Drag an image file to the upload window or click **Select File** to choose an image from a storage folder. A preview of the Help window display.
5. Click **Save Your Changes**.

i You can upload a PNG, JPEG, or GIF file with a maximum size of 8MB. The recommended image proportions are a 4:2 ratio and 652x320px resolution. See more about how Userlane renders your images in our [Working with images](#) article.

If you haven't enabled a Help link for your users, why wait? Discover how you can easily [support your users](#) directly from your application.
